

Dual Fuel Burner Light Oil/Gas Sliding/Modulating Light oil /Gas Burner M180/250/350 /600/450/550/850/1000 GL S/M

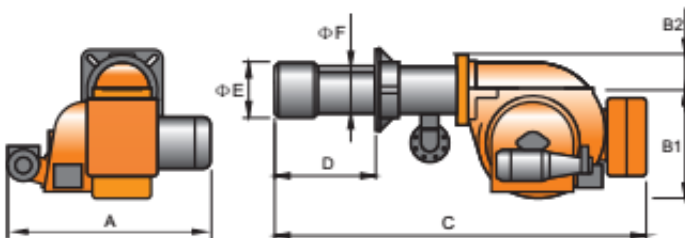

Technological performance and structural descriptions

1. Alternate methane gas/light oil burner.
2. Two-stage progressive output operation.
3. Air-gas mixing at blast-pipe and high pressure mechanical atomisation of fuel using nozzle.
4. Ability to obtain optimal combustion values by regulating combustion air and blast-pipe.

5. Maintenance facilitated by the fact that the mixing unit and the atomisation unit can be removed without having to remove the burner from the boiler.
6. Minimum and maximum air flow regulation for first and second stage by means of electric servomotor with pause closure of gate to prevent any heat dispersion to flue.
7. The servo motor which fixed with a cam can adjust the consumption for fuel and air. to prevent any heat dispersion to flue.
8. "Equipped with one flange and one insulating seal for boiler fastening.
9. Combustion air intake with air flow adjustment device.
10. Sliding boiler coupling flange to adapt to head protrusion of the various types of boilers.
11. Adjustable blast-pipe with stainless steel nozzle and deflector disk in steel.
12. A three-phase electric motor to run fan and another to run the pump.
13. Flame presence check by UV photo-electric cell.
14. Electrical plant protection rating Ip40.

| 功率 Power KW | 型号 Model | 电源 Power Supply V | 电机功率 Motor power KW | A 宽 mm Width | B1 下高mm Lower Height | B2 上高mm Upper Height | C 长 mm Length | D 筒长 mm Length of blast tube | E 头 φ mm Head diameter | F 筒 φ mm Cylinder diameter | 包装尺寸 Packing Size LxPxH mm | 重量 Net weight Kg |
|-------------------|-------------|-------------------------|---------------------------|--------------------|----------------------------|----------------------------|---------------------|------------------------------------|------------------------------|----------------------------------|----------------------------------|------------------------|
| 688 ~ 1981 | M-180GLS/M | 380V 50Hz | 3+0.55 | 880 | 445 | 230 | 1800 | 370~620 | 290 | 245 | 2070x1040x945 | 260 |
| 1127 ~ 3380 | M-250GLS/M | 380V 50Hz | 7.5+0.75 | 1110 | 570 | 260 | 1835 | 350~540 | 356 | 275 | 2070x1040x945 | 290 |
| 1304 ~ 3878 | M-400GLS/M | 380V 50Hz | 9+0.75 | 1110 | 570 | 260 | 1835 | 350~540 | 356 | 275 | 2070x1040x950 | 310 |
| 1850 ~ 5500 | M-600GLS/M | 380V 50Hz | 15+2.2 | 1100 | 570 | 290 | 1820 | 500 | 365 | 324 | 1950x1200x910 | 335 |
| 550 ~ 4000 | M-450GLS/M | 380V 50Hz | 9+2.2 | 1150 | 530 | 230 | 1592 | 327 | 290 | 316 | 1750x1250x840 | 300 |
| 600 ~ 5400 | M-550GLS/M | 380V 50Hz | 12.5+2.2 | 1150 | 530 | 230 | 1650 | 382 | 350 | 385 | 1750x1250x840 | 340 |
| 800 ~ 7400 | M-850GLS/M | 380V 50Hz | 18.5+3 | 1500 | 794 | 280 | 1900 | 430 | 480 | 469 | 2250x1600x1230 | 360 |
| 1000 ~ 10500 | M-1000GLS/M | 380V 50Hz | 22+3 | 1500 | 794 | 300 | 2100 | 430 | 480 | 469 | 2250x1600x1230 | 380 |

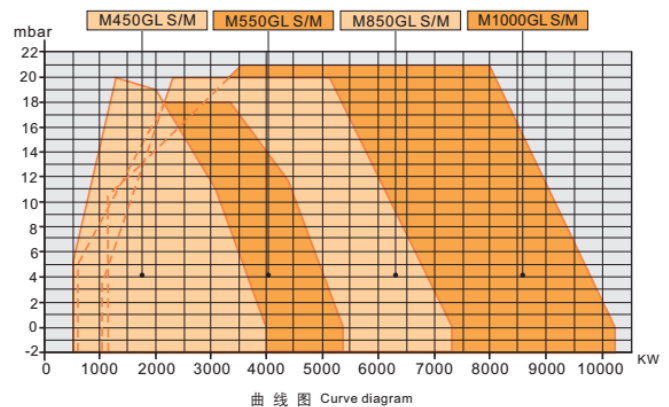
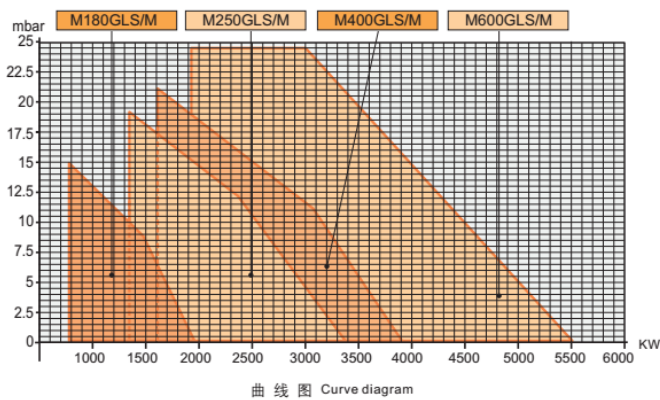

Overall dimensions

M-180、250、350GLR

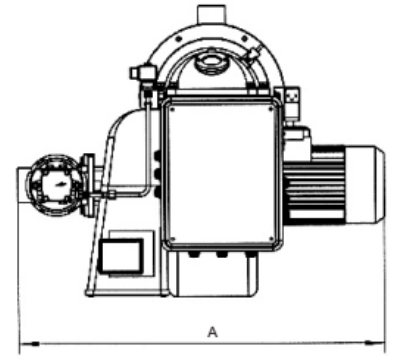
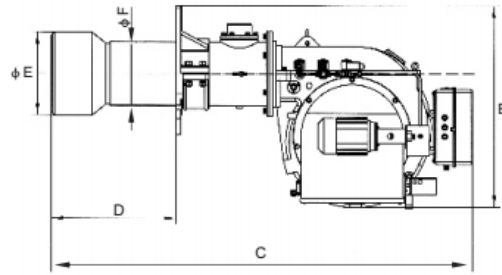

M-450、550、650、1000GLS /M

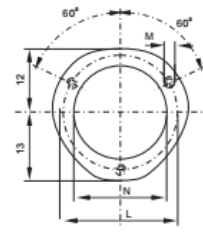
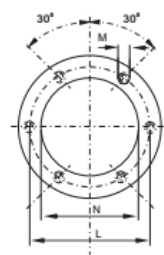
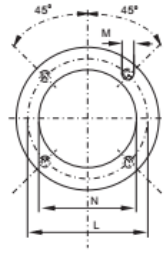
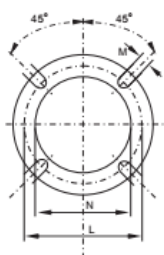
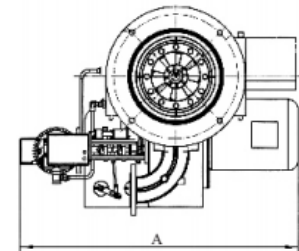
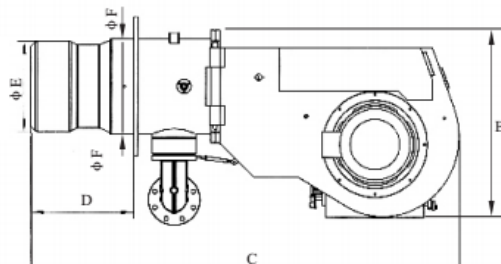

| 型号 Model | A 宽 Width mm | B 高 Height mm | C 长 Length mm | D 筒长 Length of blast tube mm | E 头 ϕ mm head diameter | F 筒 ϕ mm cylinder diameter | L 安装孔尺寸 mm The size between the installation holes | | N ϕ mm | M | NO. |
|--------------|--------------------|---------------------|---------------------|------------------------------------|-----------------------------------|---------------------------------------|---|--------|----------------|-----|-----|
| | | | | | | | 最小 min | 最大 max | | | |
| M-11GL | 475.4 | 292.5 | 595 | 40-160 | 95 | 95 | 130 | 155 | 115 | M8 | 1 |
| M-20GL | 537 | 345 | 807 | 120-280 | 135 | 114 | 170 | 206 | 145 | M10 | 1 |
| M-35GL | 537 | 354 | 858 | 140-300 | 150 | 135 | 200 | 244 | 160 | M12 | 1 |
| M-35GLR | 537 | 354 | 858 | 140-300 | 150 | 135 | 200 | 244 | 160 | M12 | 1 |
| M-40GLR | 596.5 | 435 | 1131 | 140-322 | 160 | | 233 | | 170 | M12 | 2 |
| M-100GLR | 717 | 530 | 1285 | 175-380 | 195 | | 276 | | 205 | M16 | 2 |
| M-120GLR | 809 | 645.5 | 1501 | 195-460 | 218 | | 339 | | 240 | M16 | 2 |
| M-180GLR | 810 | 675 | 1700 | 330-640 | 290 | 244 | 400 | | 300 | M18 | 3 |
| M-250GLR | 1033 | 860 | 1805 | 320-500 | 356 | 275 | 480 | 510 | 370 | M20 | 4 |
| M-350GLR | 1100 | 860 | 1805 | 320-550 | 356 | 275 | 480 | 510 | 370 | M20 | 4 |
| M-450GL S /M | 962 | 740 | 1540 | 335 | 290 | 320 | 400 | | 330 | M16 | 2 |
| M-550GL S /M | 965 | 780 | 1660 | 399 | 350 | 380 | 480 | | 390 | M16 | 2 |
| M-650GL S /M | 1125 | 1075 | 1645 | 430 | 480 | 470 | 550 | | 500 | M16 | 3 |
| M-1000GL S/M | 1230 | 1094 | 1670 | 430 | 480 | 470 | 550 | | 500 | M16 | 3 |

注：单段火为离子探针，手动调节风门控制；Protection probe.Manual adjusting air gate to control for one stage
 双段火以及比例式为UV紫外线光电眼、伺服马达控制；UV photocell, servo motor to control for two stage and modulating.
 可提供低热值、低压力燃气轻（重）油两用机以及油气混烧燃烧器；
 Able to supply the low calorific valve fuel, low gas pressure & light oil (Heavy oil) dual fuel burners and oil & gas mixing combustion burner.
 *N值为炉壁开口 “N” means the size of the hole on the chamber.

Product link : <https://www.eburn-burner.com/?p=1273>